

Rivers Edge

Davidson Homes in Murfreesboro, TN

Welcome to Rivers Edge! This stunning Murfreesboro community features large homesites and some of our most popular Tennessee plans. Connecting Veterans Parkway and New Salem Highway, Rivers Edge is in close proximity to Downtown Nashville, Franklin, and Smyrna.

Features

Excellent Schools
3-Car Garage Options

Local Schools

Barfield Elementary
Rockvale Middle
Rockvale High



Community Address

2535 Kingfisher Drive

New Homes

01

Floor Plans

02

Homes from the

\$550s

Copyright 2024 Davidson Homes LLC | All Rights Reserved | Davidson Homes is a leading builder of quality new homes across the Southeast. Davidson Homes reserves the right to adjust items listed without prior notice or obligation. Such items may include, but are not limited to, options, included features and community information, pricing, amenities, square footage, terms or availability. Features, options, floor plans, elevations, colors, dimensions and photographs are for illustration purposes and may vary from homes built. Please see your community specialist for details. Equal housing lender. Last Updated 04/23/2024.





Rivers Edge in Murfreesboro, TN

Quick Move-In Homes

UPDATED
04/23/2024

HOMES
01

Katherine Blower
Call **(615) 436-5988**



COMMUNITY ADDRESS
2535 Kingfisher Drive



\$644,900

5 Beds 3 Baths 3,158 Sq Ft

2531 Kingfisher Drive | #61

The Jennings C w/ 3-Car Garage Plan





Rivers Edge in Murfreesboro, TN

Community Homesite Map

Katherine Blower
Call (615) 436-5988



QUICK MOVE-IN

COMING SOON

SOLD

Featured Homes for Sale



The Jennings C with 3-Car Garage

2531 Kingfisher Drive

\$644,900

#61

Copyright 2024 Davidson Homes LLC | All Rights Reserved | Davidson Homes is a leading builder of quality new homes across the Southeast. Davidson Homes reserves the right to adjust items listed without prior notice or obligation. Such items may include, but are not limited to, options, included features and community information, pricing, amenities, square footage, terms or availability. Features, options, floor plans, elevations, colors, dimensions and photographs are for illustration purposes and may vary from homes built. Please see your community specialist for details. Equal housing lender.



The Bellar C



Description

From The Bellar's open, four-bedroom layout to its downstairs study, this two-story home is full of life. Discover an elegant dining room and covered patio. And the plan's kitchen overlooks a huge family room. The owners' suite features a large master bath and two walk-in closets.

BEDS
4

BATHS
3

SQ FT
2,817

PARKING
2



THE BELLAR C MAIN FLOOR PLAN



THE BELLAR C UPPER FLOOR PLAN

The Bellar C

From The Bellar's open, four-bedroom layout to its downstairs study, this two-story home is full of life. Discover an elegant dining room and covered patio. And the plan's kitchen overlooks a huge family room. The owners' suite features a large master bath and two walk-in closets. Upstairs, two bedrooms share a massive game room, ensuring that The Bellar has a little something for everyone.

Make it your own with the Bellar's flexible floor plan, featuring additional offerings like a free-standing bathtub, gourmet kitchen and sloped ceilings. Just know that offerings vary by location, so please discuss our standard features and upgrade options with your community's agent.

BEDS
4

BATHS
3

SQ FT
2,817

GARAGE
2



THE BELLAR C FLOOR PLAN OPTIONS

The Jennings C with 3-Ca...

Description



From its open layout to its optional in-home theater, this home just feels luxurious. Featuring a main-floor owners' suite and a massive, open-space kitchen, family room and dining area, The Jennings has everything you'll need. We've even added a second main-floor bedroom, a rare option.

BEDS
5

BATHS
3

SQ FT
3,158

PARKING
3



**THE JENNINGS C - 3 CAR GARAGE
MAIN FLOOR PLAN**



**THE JENNINGS C - 3 CAR GARAGE
UPPER FLOOR PLAN**

The Jennings C with 3-Car Garage

From its open layout to its optional in-home theater, this home just feels luxurious. Featuring a main-floor owners' suite and a massive, open-space kitchen, family room and dining area, The Jennings has everything you'll need. We've even added a second main-floor bedroom, a rare option. With three upstairs bedrooms, a game room and a three-car garage, The Jennings feels even larger than its square footage.

Make it your own with The Jennings' flexible floor plan, featuring additional options like a free-standing bathtub, gourmet kitchen and the aforementioned home theater. Just know that offerings vary by location, so please discuss our standard features and upgrade options with your community's agent.

BEDS
5

BATHS
3

SQ FT
3,158

GARAGE
3



**THE JENNINGS C - 3 CAR GARAGE
MAIN FLOOR PLAN OPTIONS**

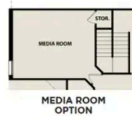

**THE JENNINGS C - 3 CAR GARAGE
UPPER FLOOR PLAN OPTIONS**